



TENMAT FF130 FLANGED LOFT CONE



FITTING INSTRUCTIONS

TENMAT FF130 Flanged Loft Cone:

Suitable for downlight cut-out diameters of 70 - 110mm

“F-Capped” Approved - Can be buried in insulation

Meets AS/NZS 3000:2007 & other international standards for a lighting product when covered with insulation

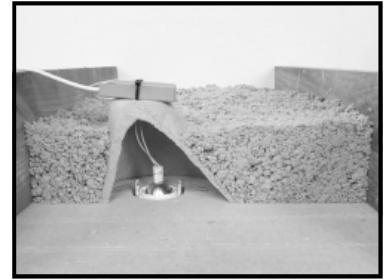

(For full testing and approval details please contact TENMAT Ltd)

STEP ONE

Make a small hole or slit in the Loft Cone for cable

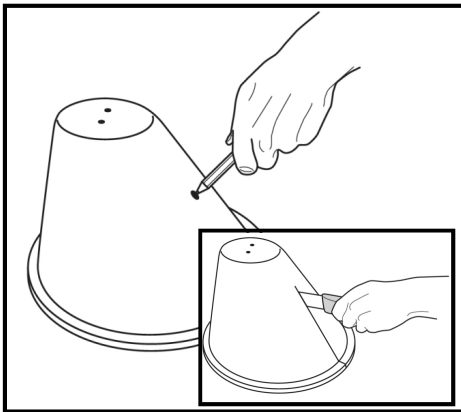

STEP TWO

After placing cover over downlight, pass cable through Loft Cone and seal up any holes or slits with silicone sealant.

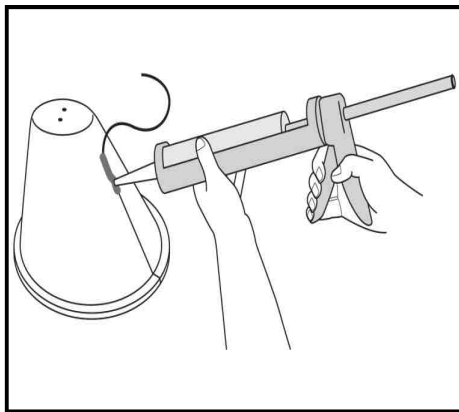

STEP THREE

If insulation level will not completely cover or bury Loft Cone, the transformer can be located on the top of the Loft Cone, securing with a nylon cable tie.

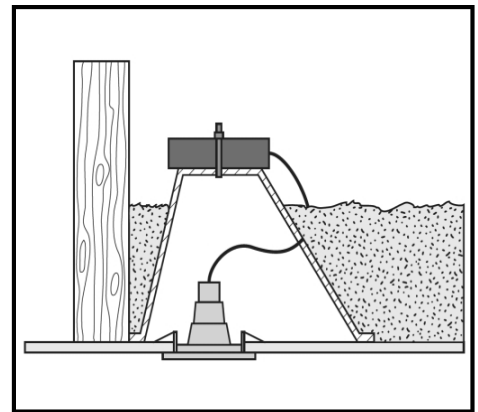

STEP FOUR

Seal around base of Loft Cone with silicone sealant to secure in place.

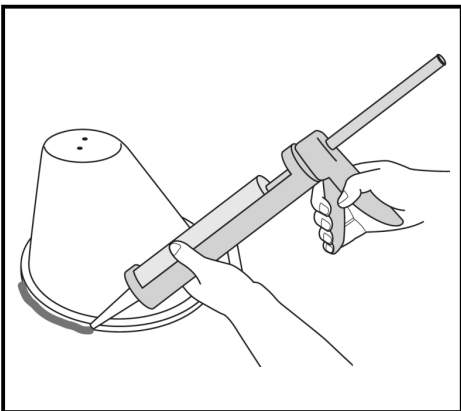

STEP FIVE

If insulation will cover or bury the Loft Cone, the transformer must be mounted clear of insulation following transformer manufacturer's recommendations.

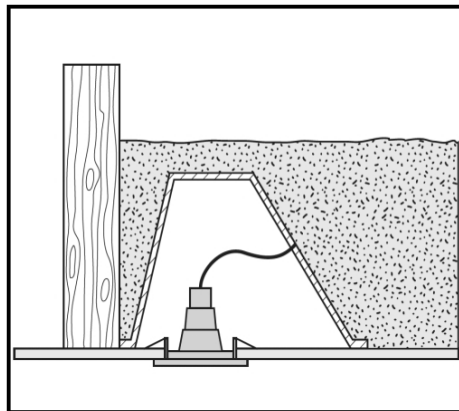

STEP SIX

NB. The Loft Cone is approved for installation in contact with combustible surfaces, e.g. timber. The downlight must be min. 25mm away from joist.

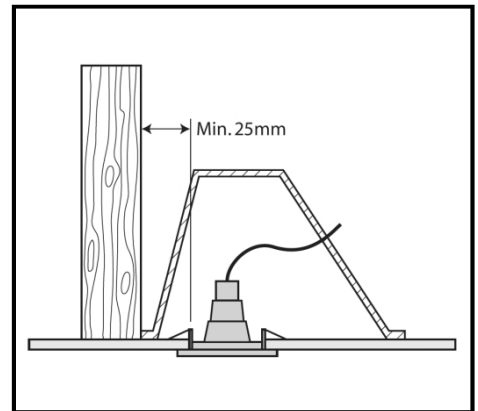

IMPORTANT

- Max. insulation depth above Loft Cone 270mm
- Ensure transformer mounted clear of insulation
- Do not place transformer under the cover
- Max. lamp wattage 50W
- Downlight should not touch inside of Loft Cone
- Downlights must be fitted in accordance with manufacturer's recommendations
- For further information please contact TENMAT

TENMAT LTD

Ashburton Road West,
Trafford Park, Manchester, M17 1RU
Telephone: +44 (0)161 872 2181
Fax: +44 (0)161 872 7596
Website: www.tenmat.com.au E-mail: info@tenmat.com.au